



DEEPENING
Discipleship

EXPANDING

Mercy

SAINT FAUSTINA CATHOLIC CHURCH



A MESSAGE FROM FATHER DAT

The future of the Church is here! At Saint Faustina Catholic Church, where we've made it our mission to live, experience and share Christ's mercy, the response has been staggering. The incredible growth and flourishing of our parish in just four years can only be attributed to the mercy of God and a community prepared to respond with love.

The question now becomes, where do we go from here? Our growth has stretched the capacity of St. Faustina beyond our ability to serve within our current facility. We have used classrooms as make-shift confessionals, hallways as meeting rooms and our sanctuary as an event space, but these stopgap measures have outlived their usefulness. It is increasingly difficult to continue fulfilling our call to make disciples of Jesus Christ and expand His mercy. Ministry groups cap their growth because of a lack of space. Our outreach efforts are often scaled back due to building constraints. Although God has inspired us to begin new ministries, we are unable to do so because we lack the necessary space.

The *Deepening Discipleship, Expanding Mercy* Capital Campaign will boldly respond to our parish's growth. A new community and education center with a large conference room, youth room, 17 classrooms and 10 new parish offices will provide us the space for ministries to flourish for generations to come. A new rectory will give our parish the living presence of its shepherds and provide for development of future priests for the archdiocese with resident seminarians. And eliminating our remaining debt will free up opportunities to expand.

The question remaining for all of us is simple. How will each of us get involved? Will we support this campaign with a sacrificial and grateful gift, giving of ourselves for the future of our parish community? With God's grace we have built our parish, and now we must keep moving forward to build facilities that respond to the gift of growth God has given us. I call upon our community to prayerfully and generously offer our gifts with a profound trust that God will bless and multiply them. As we do so, pray with me that God may continue to shower His blessings upon our parish, enabling us to deepen our discipleship and expand His mercy!

In Christ's name,

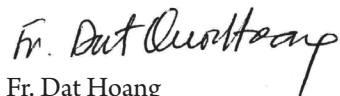

Fr. Dat Hoang
Pastor



CAMPAIGN PRAYER

Loving and Merciful God,

You have called us together as a community under the patronage of St. Faustina to tell the world of your Mercy. Bless and form our community, that we may truly be a place where your Love and Mercy is lived, experienced and shared.

May we be the living extension of your welcoming embrace, so that every soul may be led to take refuge in your Unfathomable Mercy. Mold us and help us to grow according to your Holy Will. As we come together to build and expand your Heavenly Kingdom, open our hearts to generously place our gifts at your disposal with profound trust that You will bless and multiply them as You please. Guide our every step and increase your Mercy within us. We ask for your guidance and blessing as we call upon the intercession of our Heavenly Mother and place our trust in You.

St. Faustina, Pray for us!



OUR PURPOSE AND OUR OPPORTUNITY

GROWTH

Since our inception in July 2014, meeting for worship in an elementary school, our parish has rapidly grown to a parish community with more than 3,200 registered families. In less than five years, we've become the fastest-growing parish in the archdiocese with more students in faith formation than some of the archdiocese's largest parishes. That growth shows no signs of slowing. Fort Bend County is expected to grow by 368 percent over the next few decades to a population of more than 2.1 million. It is our responsibility as a parish to meet the spiritual needs of this growing populace.

OPPORTUNITIES FOR MERCY

Currently, our parish is pushing at the seams of our existing building. It's a scramble to respond to the needs of groups that want to meet and plan events that give life to our parish. The growth of our parish has been accompanied by growing pains, including:

- Many new ministries have been turned away because of a lack of space and available meeting times.
- Over half of our 2,000 faith formation students must complete classes at home because there are not enough classrooms.
- Dozens of teens have been waitlisted for youth ministry because we lack the volunteers and facilities to accommodate them in our program.
- Many other ministries have hit capacity for the small meeting rooms we have available.
- Our youth ministry programs rely on a hodgepodge of meeting spaces, including hallways and storage rooms that detract from their sense of belonging on our campus – one of the chief values we are hoping to convey to our youth.
- Our priests' residence is five miles away from the church, disconnected and inconvenient with all this activity.

OUR CALL

The mission of Saint Faustina Catholic Church is to be a place where the love and mercy of God is experienced, lived and shared. Our efforts to fulfill that mission are currently hampered by a lack of space. The theme of our campaign is ***Deepening Discipleship, Expanding Mercy – a call to ensure all parishioners are offered the opportunity to be brought into a deeply intimate relationship with our Lord and sent to share His mercy with others.*** This call necessitates the continued physical growth of our parish campus.

OUR PARISH BY THE NUMBERS

Likely,
as many as
4,000
households
if
unregistered
are
counted.

Over
10,000
people
call
St. Faustina
their
spiritual
home.

48 %
of our
parishioners
are
under 21
years
old.

Over
2,000
students
involved
in
faith
formation.

OUR PRIORITIES

PRIORITY GOALS



1 COMMUNITY AND EDUCATION CENTER \$11,400,000

As we increase in size as a parish community, we must also commit to grow closer to Christ and closer together in community. To do so, we need more meeting, class and event space. The new community and education center will feature:

- 17 new classrooms and meeting rooms for parish groups and ministries to use.
- 2,954-square-foot Mass overflow and events space that can be configured for multiple uses.
- 10 new staff offices to expand ministries available to parishioners.
- 1,599-square-foot youth room configured specifically for youth activities.
- Approximately 350 new parking spots.
- Enhanced landscaping as we build out the campus.
- The new facility will also provide the foundational first floor for an eventual elementary school to be built in future campus phases.



2 RECTORY (ONSITE PRIEST RESIDENCY) \$600,000

To meet the increasing demands on our priests and the need to bring seminarians in for formation, the parish has proposed building a rectory on parish property for the priests' residence. The parish will sell the existing rectory once the new one is built. The new rectory will fulfill the need for an on-site home for our pastor, priests and their guests. The new rectory will include:

- Small chapel.
- Open living room and dining room for social gatherings.
- 5 priest suites and 1 guest room.
- Kitchen and patio area.



3 IGNITE CAMPAIGN \$676,000

Every parish in the Archdiocese of Galveston-Houston is required to participate in the IGNITE: Our Faith, Our Mission Capital Campaign. This very important archdiocesan-wide campaign seeks to raise \$150,000,000 with the funds restricted for use in the following areas:

- Addressing renovations and modernization of St. Mary's Seminary
- Funding two educational endowments
- Supporting Faith Formation
- Future Disaster Recovery Fund
- Rebuilding our Parishes & Schools in light of Harvey



We have included our IGNITE campaign commitment into our total campaign goal. By including our commitment, our parish is only subject to conduct one all-encompassing campaign versus multiple efforts at the same time. More details on the IGNITE Capital Campaign are available on the Archdiocesan website at www.archgh.org.

COSTS AND FUNDRAISING GOALS

OUR CAMPAIGN GOAL IS \$11,400,000

COSTS OF OUR CAMPAIGN INITIATIVES

Community and Education Center	\$11,400,000
Rectory	\$600,000
IGNITE (St. Faustina's Goal)*	\$676,000

Total Costs	\$12,676,000
--------------------	---------------------

*By incorporating our IGNITE goal into our capital campaign for building these new facilities, St. Faustina will be exempt from the archdiocesan 10 percent tax assessed on all parish revenues (e.g. if we achieve our goal of \$11,400,000 in this campaign, by including IGNITE, we are exempted in full from the archdiocesan tax which would otherwise have been \$1,140,000).

REMAINING DEBT \$5,795,431

The current balance of our parish's loan with the archdiocese is \$5,795,431 for the purchase of land and construction of our current building, which houses a worship space, classrooms and offices. Principal and interest on this debt currently costs the parish about \$550,000 per year.

ACHIEVING AND COLLECTING OUR \$11,400,000 CAMPAIGN GOAL WILL ALLOW US TO MOVE FORWARD WITH CONSTRUCTION.

Current archdiocesan guidelines provide that they will finance 50% of our building project when we meet the following requirements:

- Pay off existing debt
- Have 50% of construction costs in the bank

Early campaign redemptions will be used to pay off our existing debt of \$5,795,431. The savings realized will be accumulated to our cash needed to obtain the new loan from the archdiocese.



HOW YOU CAN HELP

DEEPENING DISCIPLESHIP, EXPANDING MERCY

There are many beautiful churches that sit empty because there is no sense of community and no engrained sense of discipleship among parishioners. We want our parish to be filled with deeply committed disciples of Christ who will sustain and build our church community!

NAMING OPPORTUNITIES

To acknowledge and memorialize our largest gifts, St. Faustina is offering the following naming opportunities. The business office will work with each donor to ensure that their intent is realized. Your name, your company's name, your family's name, or those you wish to remember will be memorialized through recognition plaques honoring your gift.

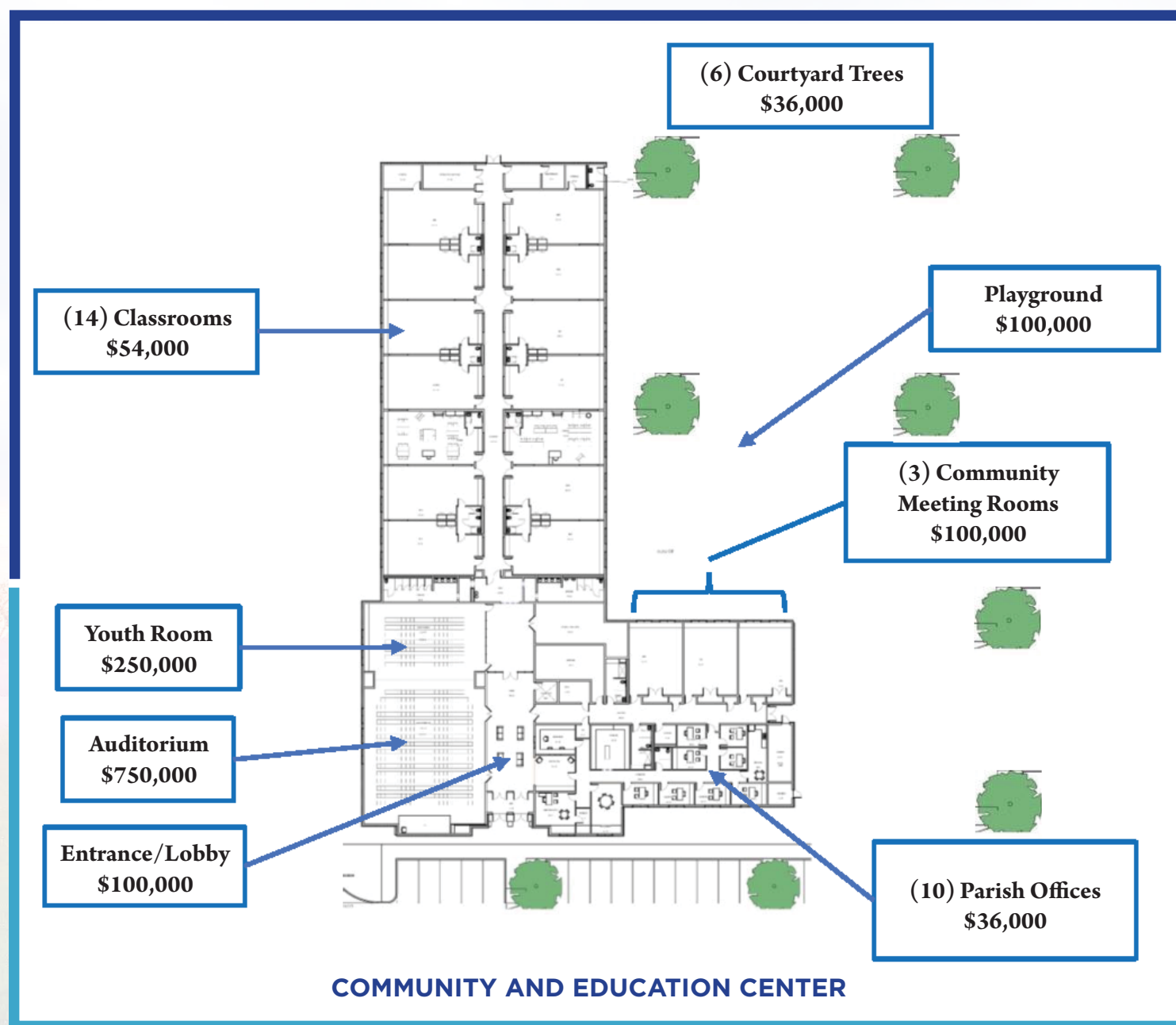

All gifts of \$3,000 and more will be recognized on a donor recognition wall.

METHODS OF GIVING

To achieve our goals as a parish and grow in a prudent way, your generous, meaningful and sacrificial support is needed. Commitments to the *Deepening Discipleship, Expanding Mercy* Capital Campaign may be made over a suggested three-year period and can be made in several ways.

CREDIT/DEBIT CARD/AUTOMATIC TRANSFER The easiest way for processing your gift is online through your Faith Direct account. You may choose to have your gift drawn directly from your bank account (lowest fee for the parish) or credit or debit card as a one-time payment or a recurring payment.

CASH/CHECK Gifts may also be made by check/cash through recurring payments over the three-year commitment period.

SECURITIES Stocks, bonds or mutual fund shares that have appreciated can have an immediate impact on our campaign and create an income tax deduction for you based on their current value. Because there is no capital gains tax when you make a charitable gift, you receive an additional tax benefit above and beyond the charitable gift donation.

MATCHING GIFTS Several local companies offer matching gift programs for employees. This allows donors to maximize their giving potential. For information and required forms, check with your company's human resources department.

PLANNED GIFTS Planned giving is the process of carefully selecting the best method and asset for making a charitable gift. Such a gift can enable you to take full advantage of the tax laws to accomplish your financial and charitable goals. Planned gifts can be made through bequests by will or living trust, charitable remainder trusts, charitable lead trusts, charitable gift annuities, beneficiary benefits from life insurance, IRAs, pensions, or financial accounts.

You may benefit from gifts with a charitable deduction on your tax return. Please consult your tax professional for advice.

BUDGET YOUR GIFT OVER THE THREE-YEAR INTENTION PERIOD

TOTAL GIFT	ANNUAL	SEMI-ANNUAL	QUARTERLY	MONTHLY	WEEKLY*	DAILY*
\$1,095	\$365	\$183	\$91	\$30	\$7	\$1
\$1,800	\$600	\$300	\$150	\$50	\$12	\$2
\$3,600	\$1,200	\$600	\$300	\$100	\$23	\$3
\$5,400	\$1,800	\$900	\$450	\$150	\$35	\$5
\$7,200	\$2,400	\$1,200	\$600	\$200	\$46	\$7
\$9,000	\$3,000	\$1,500	\$750	\$250	\$58	\$8
\$12,000	\$4,000	\$2,000	\$1,000	\$333	\$77	\$11
\$15,000	\$5,000	\$2,500	\$1,250	\$417	\$96	\$14
\$24,000	\$8,000	\$4,000	\$2,000	\$667	\$154	\$22
\$36,000	\$12,000	\$6,000	\$3,000	\$1,000	\$231	\$33
\$54,000	\$18,000	\$9,000	\$4,500	\$1,500	\$346	\$49
\$100,000	\$33,333	\$16,667	\$8,333	\$2,778	\$641	\$91
\$250,000	\$83,333	\$41,667	\$20,833	\$6,944	\$1,603	\$228
\$500,000	\$166,667	\$83,333	\$41,667	\$13,889	\$3,205	\$457
\$1,000,000	\$333,333	\$166,667	\$83,333	\$27,778	\$6,410	\$913

* The daily and weekly figures are provided for illustration only.



PASTOR

Father Dat Hoang

HONORARY CHAIRS

Clifton and Frances Aldrich
Jean DeCicco

CAMPAIGN CABINET CHAIRS

John and Brenda Gillespie*
Gary and Dana Newberry*

CAMPAIGN CABINET

Benny and Gale Bixenman
Rich and Isabel Chandler
Nguyet and Jordan Dau and Mueller
Guillermo and Miriam De los Cobos
Brian and Belisa Dias
Richard and Jo Engelhart
Beverly Fisher*
Jessie and Loretta Fontenot
Philip and Cirila Gamache
Luis and Adriana Gamboa
Carlos and Mary Gonzales
Patrick and Rosie Hearn*
Carlos and Mary Hernandez*
Keith and Donna Kahl
Ron and Cheryl Mersman
Michael and Veronica Mullenix*
Jason and Laura Peart
Brian and Carrie Sinosic
Aaron and Melissa Sobel
Terrel and Gaylin Soderstrom
Jeff and Lisa Thigpen
Chuck Tortorich
Dionicia Venegas

PRAYER COMMITTEE

Karla Pitre
Lucy Vargas
Pete Dodd
Doris Choyce

SPECIAL EVENTS COMMITTEE

Teresa Martin Prieto
Holly Burke

*Denotes Strategy Team Member